

X-SPACE



PREFAB HOUSE

**CONTAINER HOUSE  
MANUFACTURER**



bunk house
Container House
Container Home
Steel Structure
Steel Villa
Portable Toilet

## Introduction:

Anyang ZhongZheng Steel Structure Co.,Ltd & Modular Housing is a 100% exporting factory which has more than 17 years experience in prefab houses industry. Our factory is located in Anyang city ,Henan Province , area 20000m2 and office located in Anyang,Henan Province China, where is famous for all kinds of construction materials, furnitures & aluminum products.

We have seven production lines, folding container house, flat pack container house, expandable container house, detachable container house,bunk house,steel structure and sandwich panel production lines.Zhong Zheng is the No.1 Folding Container House Manufacturer in China.We have the LARGEST Folding Container house Sales to oversea markets.



Our products including Container Houses, Container Homes, Container School, Container Office & Hotel buildings, Prefab bunk house, Steel Structures, Light Steel Villas, Portable Toilets & Security Posts.

Our quality system has been audited for CE, TUV, ASTM,BV, SGS & ISO9001:2015 and we all obtained reports of approval. Our enthusiastic sales teams&international installation teams are well known in prefab house industry. We have confidence to turn every one of our business into a happy long-time cooperation.

Our major markets are Middle East, Africa, South America & South-East Asia. We have successfully completed many projects in Thailand, Philippines, Malaysia , Oman, Qatar, Saudi Arabia, Uruguay, Congo, Brazil, Mexico, Argentina, Chile, USA, Germany, Australian and so on.

# FOLDING CONTAINER HOUSE (CAMP)



Size: 2.5MX5.8MX2.6H

## Features:

1. 4 minutes can install 1 house.
2. Galvanized steel structure.
3. 40mm fireproof IEPS sandwich panel for wall & 100mm glass wool for roof.
4. Aluminum sliding windows with security bar.
5. Fireproof IEPS sandwich panel door.
6. 18mm MGO board for floor.
7. When is folded, the height is only 350mm.
8. Include electrical.



with toilet



## Why Choose Us

Overall force & fully folded

One 40HQ can load 12 units  
Saves 20% shipping cost  
Others just load 10 units

IEPS fire proof & water proof sandwich panel for wall and roof  
Others do not have this performance

The special arc design for the rooftop.  
Total sealed rim!  
100% waterproof!

Factory



Other Suppliers



Connection



Accommodation



Office

# FOLDING FALT PACK CONTAINER HOUSE

(This luxury foldable container house is widely used for bunk camp, office, dormitory & store room.  
Loading: 1x40HQ can load 10 units.)



Size: 2.52MX5.92MX2.65H



## Features:

1. Higher Quality & Luxury!
2. 100% water proof!
3. 50mm Sandwich panel for wall; 100mm glass wool insulation for roof!
4. PVC double glass sliding windows.
5. Steel door with high quality handle lock.
6. 18mm MGO board for floor.
7. Including basic room electrics.



## — Typical Projects —



# FLAT PACK CONTAINER HOUSE

(This flat pack container house is popular used for office, dormitory & shop.  
Loading: 1x40HQ can load 8 sets.)



Size: 2.425MX5.9MX2.8H



Empty



with Toilet



Toilet



Shower room

## Features:

1. Come with completed roof & floor.
2. Electric wires run over ceiling, including DB, breaker, power inlet & sockets.
3. Fully Galvanized Steel Structure.
4. 50MM EPS/Glass wool sandwich panel for wall & 100mm glass wool for roof.
5. Steel door & UPVC double glass windows with security bar.
6. Steel sheet modern indoor lining.
7. 18mm Fiber Cement Board for flooring

## Installation:



## — Typical Projects —



- Container villa
- Container dormitory
- Container office
- Container hotel



# DETACHABLE CONTAINER HOUSE

(This container house is widely used for office, apartment & shop.  
Loading: 1x40HQ can load 15 units.)



3MX5.95MX2.85H

- 1. Separate steel structure.
- 2. Can load in 20ft container.
- 3. Customized size.
- 4. No need crane to install.



## Features:

1. Galvanized steel structure.
2. 50mm 50mm EPS/Fireproof Glass Wool/Rock Wool Sandwich panel for wall.
3. 0.476mm steel sheet+50mm glass wool+steel sheet ceiling for roof.
3. Aluminum Sliding Windows with Security Bar.
4. Steel door.
5. 18mm MGO board for floor.

## Projects:



# EXPANDABLE TINY HOUSE

(This expandable tiny house is popular used for villa resort, hotel, office, accommodations & shops.)



Size: 2.3M X 4.6M X 2.5H

## Features:

1. Structure: Steel structure frame, square tube beam and sandwich panel combination
2. Flooring: 15mm WBP plywood (waterproof and fireproof)
3. Wall: 40mm EPS sandwich panel
4. Door: 40mm EPS sandwich panel door
5. Window: Aluminum alloy sliding window
6. Accessories: adjusting footing, wheels

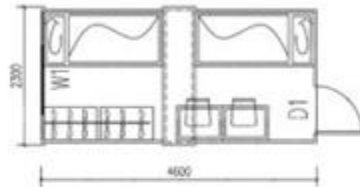

## Inside:



**Install:** 4 people 10 min install 1 house!



**Parameters:**

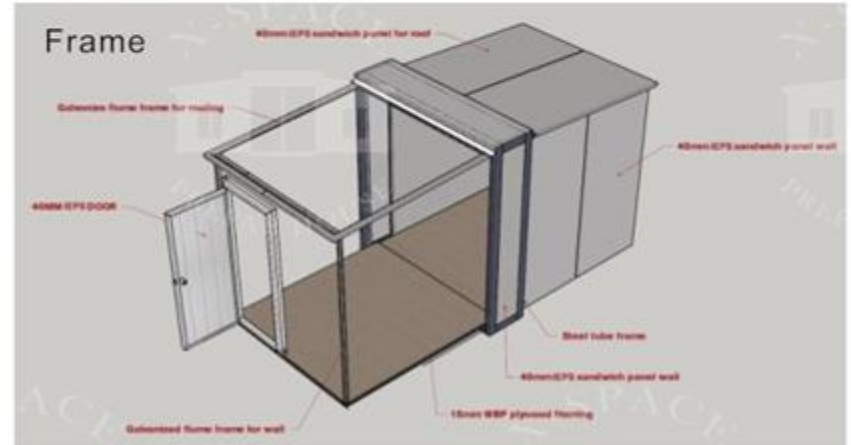

**Loading:** 1x40'HQ load 20 units!



**Project:**



# EXPANDABLE CONTAINER HOUSE

(This expandable container house is widely used in Emergency Function, Disaster Relief, Remote Site Deployment, Field Clinic, Site Offices etc.)



**6 People install 1 house within 1 hours**

## Features:

1. Floor: Steel structure + Bamboo Composite Board + PVC tile flooring;
2. 50mm EPS sandwich panel (Optional 50mm Glass wool sandwich panel)
3. Roof: 100mm glass wool insulation(Main body) + 50mm EPS sandwich panel(Extension)
4. Window: Aluminum Up-swing window(Optional UPVC double glass sliding window)
5. Door: Glass sliding door + Sandwich panel doors.



## Plans:

5 steps 1 hours a home



**Type A 27.84m<sup>2</sup> (6 sets/40HQ)**



Opening Size: 5.8MX4.8MX2.5H  
Closing Size: 5.8MX0.7MX2.5H



**Type B 36.54m<sup>2</sup> (2 sets/40HQ)**



Opening Size: 5.8MX6.3MX2.5H  
Closing Size: 5.8MX2.2MX2.5H



**Type C 24.65m<sup>2</sup> (2 sets/40HQ)**



Opening Size: 5.8MX4.25MX2.5H  
Closing Size: 5.8MX2.2MX2.5H



**Type D 73.08m<sup>2</sup> (1 set/40HQ)**



Opening Size: 6.3MX11.6MX2.5H  
Closing Size: 2.2MX11.6MX2.5H







# CONTAINER RESORT



# CONTAINER Hotel

COMBINED BY FLAT PACK CONTAINER HOUSE



1. Economic design: Type A+Type B  
Luxury design: Type C +Type D
2. Office design: Inside have office, manager room, meeting room, public toilet etc.
3. Accommodation design: Inside have reception room, bedrooms, canteen, public toilet, gym ect

Type D



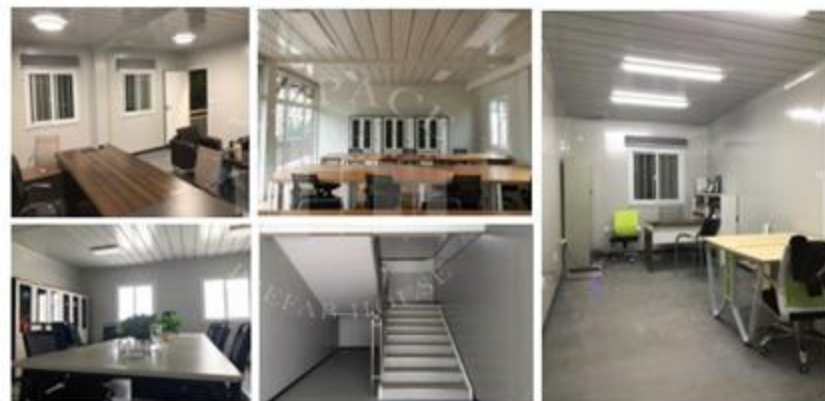

Manager room, office, reception room, meeting room, toilet

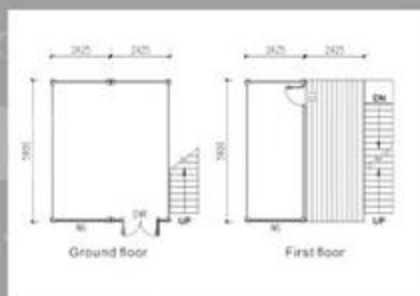

Type A: 4.85MX5.9MX5.6H

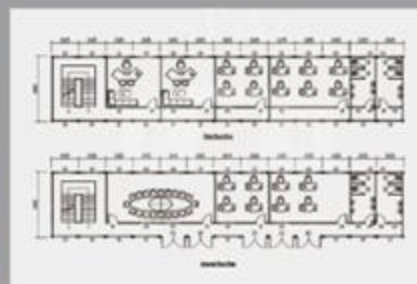

Type C: 31.525MX5.9MX5.6H

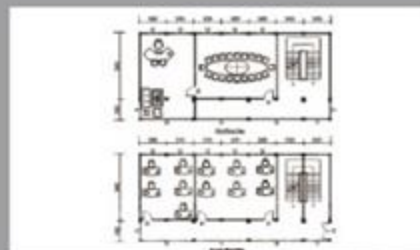

Type B: 7.7MX16.975MX5.6H

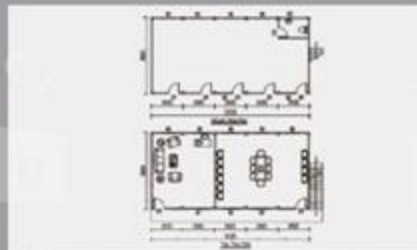

Type D: 12.125MX5.9MX5.6H

# CONTAINER MALL & CONTAINER SHOP



**Type A** flat pack container  
Two floor coffee shop 46.5m<sup>2</sup>  
Group floor: expandable design  
First floor: with balcony

**Type B** ★★★★★  
Folding container store 14.5m<sup>2</sup>  
Economic shop

**Type C** ★★★★★  
Flat pack container store 14.31m<sup>2</sup>  
Economic shop



Made by flat pack container houses

**Type D** ★★★★★  
Flat pack container store 14.31m<sup>2</sup>  
Extended awning 14.31m<sup>2</sup>  
Total 28.62m<sup>2</sup>

**Type E**  
Luxury container shop  
Total 14.31m<sup>2</sup>

**Type F** ★★★★★  
One floor shop 7m<sup>2</sup>  
Extended awning 7m<sup>2</sup>  
Total 14.31m<sup>2</sup>



# WORLD CUP CONTAINER

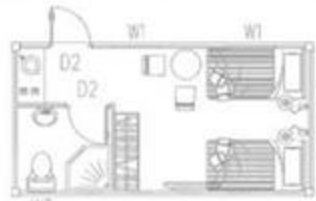

Size: 3MX5.95MX2.85H



# CONTAINER SCHOOL



Accommodation



Classroom

Type A (24 students)



5.9MX9.7MX2.8H



Classroom

Type B (96 students)



5.9MX19.4MX5.6H

# PREFAB K CLASSROOM



Office



Type C (20 students)

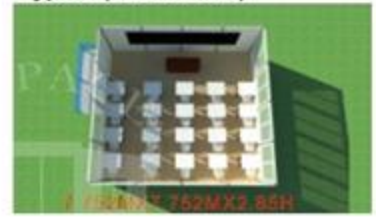

4.42MX7.752MX2.85H



Type D (60 students)



5.62MX22MX2.85H



Accommodation



Meeting room



Toilet



Dining

# PREFAB LABOR CAMP( K HOUSE)

(This K prefabricated house is widely used in construction sites and labor camp for dormitory, canteen, clinic and laundry room.)



3KX12KX3P Canteen

7KX20KX6P Dormitory

K house with steel chassis



**Type A: 3KX12KX3P Dormitory**  
Length: 22m, Width: 3.115m

**Type B: 3KX12KX3P Dormitory**  
Length: 22m, Width: 3.115m

**Type C: 4KX20KX3P Dormitory**  
Length: 30.014m, Width: 3.115m

**Type D: 6KX12KX3P Canteen**  
Length: 21.018m, Width: 3.115m

**Type E: 6KX12KX3P Bathroom**  
Length: 27.818m, Width: 3.115m

**Features:**

- 1."C" section steel for columns and beams.
- 2.50mm EPS/Rock wool/ Glass wool/ PU sandwich panel for wall & roof.
- 3.PVC windows and sandwich panel doors.
- 4.1x40HQ can load around 280-320 m2.

## The area comparing form of slope style house

K house:1K=1.82m,1P=0.95m

Length	Width	ONE FLOOR(3P)			TWO FLOOR(6P)			THREE FLOOR(9P)		
		3K	4K	5K	3K	4K	5K	3K	4K	5K
4	K	45.53	59.07	72.61	103.79	130.87	157.95	176.04	216.66	257.28
5	K	56.67	73.52	90.38	126.97	160.68	194.39	211.27	261.83	312.39
6	K	67.81	87.98	108.14	150.16	190.49	230.82	246.51	307.01	367.50
7	K	78.95	102.43	125.90	173.35	220.30	267.26	281.74	352.18	422.61
8	K	90.09	116.88	143.67	196.53	250.11	303.69	316.98	397.35	477.72
9	K	101.22	131.33	161.43	219.72	279.93	340.13	352.21	442.52	532.83
10	K	112.36	145.78	179.19	242.91	309.74	376.57	387.45	487.70	587.94
11	K	123.50	160.23	196.96	266.09	339.55	413.00	422.68	532.87	643.05
12	K	134.64	174.68	214.72	289.28	369.36	449.44	457.92	578.04	698.16
13	K	145.78	189.13	232.48	312.47	399.17	485.88	493.16	623.21	753.27
14	K	156.92	203.58	250.25	335.65	428.98	522.31	528.39	668.38	808.38
15	K	168.06	218.03	268.01	358.84	458.79	558.75	563.63	713.56	863.49
16	K	179.19	232.48	285.77	382.03	488.61	595.19	598.86	758.73	918.60
17	K	190.33	246.93	303.54	405.21	518.42	631.62	634.10	803.90	973.71
18	K	201.47	261.38	321.30	428.40	548.23	668.06	669.33	849.07	1028.82
19	K	212.61	275.84	339.06	451.59	578.04	704.49	704.57	894.25	1083.93
20	K	223.75	290.29	356.83	474.77	607.85	740.93	739.80	939.42	1139.04
21	K	234.89	304.74	374.59	497.96	637.66	777.37	775.04	984.59	1194.15
22	K	246.02	319.19	392.35	521.15	667.48	813.80	810.27	1029.76	1249.26

### Explanation:

The two floor's house has two pcs stair in standard.Each side of gable wall has one.The stair's area is 4.5m<sup>2</sup>/pc.The three floor stair is 16m<sup>2</sup>/pc.The area will increase or reduce according the stair's quantity.

- The regular of area counting way:
- 1.The house area:Exterior wall length × exterior wall width × floor number
  - 2.Standard stair:4.5m<sup>2</sup>/pc,corner stair(special for three floors house):16m<sup>2</sup>/pc.
  - 3.Awning area:house shadow area × 0.5.
  4. Aisle board area:house shadow area.
  - 5.Total area:①+②+③+④
  6. Except the no standard house,this regular is suitable for all the house.
  - 7.Above regular also is fit for the flat style house.

### Features:



Steel structure

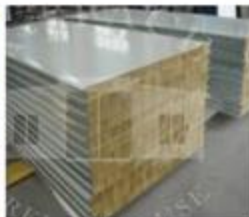

Wall panel



Roof panel

## REFUGEE HOUSE

(Apartment design, have living room, bedroom, bathroom and outside kitchen.  
All the steel can be galvanized, the service time can more than 20 years.)



3K × 4K × 3P (total is 41.8 m<sup>2</sup>)



3K × 5K × 3P (total area is 52m<sup>2</sup>)



one bedroom

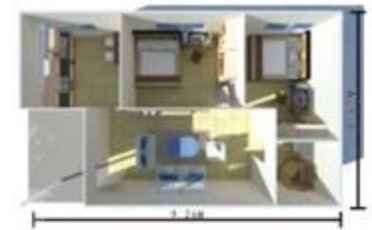

two bedrooms

### Features:

1. Steel structure.
2. 50mm EPS/Glass wool sandwich panel for wall and roof.
3. PVC windows and sandwich panel doors.
4. Easy to assemble and disassemble for several times.



Where Wellcamp is where a dream is



# PREFAB LABOR CAMP ( T HOUSE )

(This T prefabricated house is widely used in construction sites and labor camp for dormitory, canteen, clinic and office.)



## Features:

1. Square tube steel for columns and beams,
2. 50mm EPS/Rock wool/ PU sandwich panel for wall & roof.
3. Aluminum sliding windows and sandwich panel and steel doors .
4. Modern design. All the steel structures are hidden inside.



Simple home



Uganda Dormitory



# SUDAN HOME

(With steel base and sandwich panel for wall and roof. This kind of house is widely used for refugee houses and labor camp house.)



## Features:



3M×6M×2.8H  
one bedroom with toilet

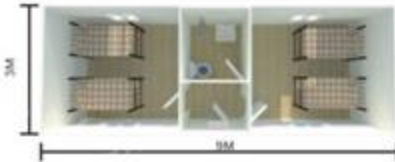

3M×9M×2.8H  
two bedrooms with toilet



3M×12M×2.8H  
3M×9M×2.8H  
two bedrooms, living room, toilet



# ACCESSORIES

## DOOR

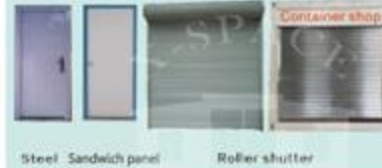

Steel Sandwich panel Roller shutter

## KITCHEN CABINET



## FLOOR



Ceramic Tile PVC Tile

## HOT HOT SALES



Steel bunk bed Folding bed

## SANITARY WARE

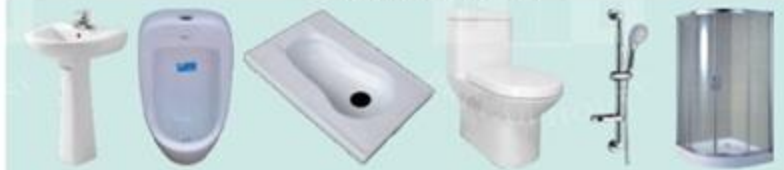

Wash Basin Urinal Squat Toilet Sitting Toilet Shower Head Shower room

## ACCESSORIES



300 Aluminum 600 PVC Gypsum Lighting tile Ventilation ball Switch & Socket

# LIGHT STEEL VILLA

(Steel structure, sandwich panel for wall and roof, steel doors and aluminum sliding windows.)



Sandwich panel villa (simple villa)



Sandwich panel villa (simple villa)



105.59m<sup>3</sup> (3 bedrooms)



72.2m<sup>3</sup> (3 bedrooms)



50.54m<sup>3</sup> (2 bedrooms)

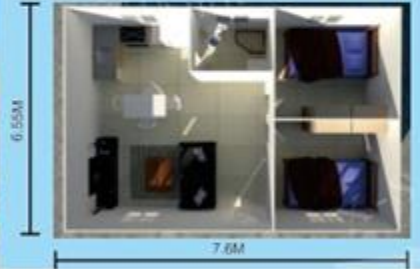

# PORTABLE TOILETS

(These portable toilets are widely used in playgrounds, parks, construction sites & labor camp.)



## Type A

1. Material: EPS panel; steel
2. Size: 1.15mX1.15mX2.3m
3. Fittings: Squat toilet bowl; washing basin; water tap; Ventilation fan; lock.
4. Weight: 125KGs.
5. Transportation: This model can be shipped disassembled or fully assembled.



## Type B

1. Material: Plastic; UV-proof.
2. Size: 1.15mX1.15mX2.3m
3. Accessories: Seated toilet bowl; waste tank; washing basin; water tap; ventilation pipe; foot pumps; mirror; in-use indicator; gender sign.
4. Weight: 115KGs.
5. Transportation: 20GP: 30units/40HQ: 65units.



## Type C

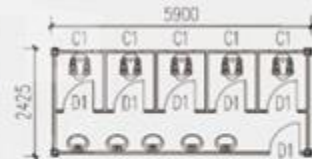

## Type D



Container toilet Inside



Sandwich panel toilet



HDPE toilet

# STEEL STRUCTURE



## Features:

1. "H" section steel for columns and beams.
2. 50mm EPS/PU sandwich panel or 0.476mm single steel sheet for wall & roof.
3. Aluminum sliding windows and steel sliding door or roller shutter door.
4. With the lighting tiles, ventilation balls, galvanized gutters & water pipes.



# STEEL SHEDS

(These steel sheds warehouse can use the single steel sheet or sandwich panel for roof and wall. Also can do the brick wall in local.)



Qatar warehouse house



cow shed



chicken shed

## Installation:



Steel structure



Foundation 1



Foundation 2



Brickwall & panel



# PROJECTS

(Our container houses, prefab houses, steel structures have already sold to 48 countries all over the world.)



Thailand Project



Kuwait project



Guangzhou Project



Myanmar Project



Costa Rica Project



Malaysia Project



Uzbekistan Project



India labor camp



Saudi Warehouse



Sandwich Guard House



Stainless Guard House



Sandwich panel toilet



Oman labor camp



Qatar labor camp



India labor camp



Yemen labor camp



Uganda labor camp



Syria refugee housing

# PROJECTS





## Verification of Conformity

LN 00288

No.: ICR Polska/VC/HE220805

**Name and address of Applicant**  
Anyang Zhong Zheng Steel Structure Co., Ltd.  
Northwest corner of the intersection of Yingbin Road and Tengfei Road ,Guxian Town ,  
Tangyin Country ,Anyang City ,Henan Province,China.

**Name and address of manufacturer:**  
Anyang Zhong Zheng Steel Structure Co., Ltd.  
Northwest corner of the intersection of Yingbin Road and Tengfei Road ,Guxian Town ,  
Tangyin Country ,Anyang City ,Henan Province,China.

**Product name:**  
expandable container house detachable container house foldable container house

**Product types:**  
dcgtsy-63118-001, dcgtsy-63118-002, dcgtsy63118-003, dcgtsy63118-004,  
dcgtsy63118-005, dcgtsy63118-006, dcgtsy63118-007, dcgtsy63118-008,  
dcgtsy63118-009, dcgtsy63118-010, dcgtsy-6359-001, dcgtsy-6359-002,  
dcgtsy-6359-003, dcgtsy-6359-004, dcgtsy-6359-005, dcgtsy-6359-006,  
dcgtsy-6359-007, dcgtsy-6359-008, dcgtsy-6359-009, dcgtsy-6359-010,  
dcgtsy-6390-001, dcgtsy-6390-002, dcgtsy-6390-003, dcgtsy-6390-004,  
dcgtsy-6390-005, dcgtsy-6390-006, dcgtsy-6390-007, dcgtsy-6390-008,  
dcgtsy-6390-009, dcgtsy-6390-010

**Product trademark:** n/a

This document confirms that the product sample meets the requirements of the following standards:

- Related with Regulation (EU) 305/2011:  
EN 1090-1:2009+A1:2011

The assessment process has been carried out in accordance with individual rules and conditions agreed with the applicant. Evaluation has been carried out in accordance with:

**Test reports:** CE-HR20220825-HBDC-1  
**Tests conducted by:** Anyang Zhong Zheng Steel Structure Co., Ltd.

**Issue date:** 25.08.2022

**Expiration date:** 24.08.2027

**Remarks**  
This Verification of conformity refers to the above mentioned product and its conformity in regards of above mentioned standard(s) was proven on test sample.  
This Verification of conformity was issued on voluntary basis and does not imply meeting all essential requirements, assessment of the series-production or any other restricted Notified Bodies conformity assessment procedure appropriate for the product.



**marking remarks:**  
mark is not sanctioned by the following verification of conformity mark given here as reference, can be only use by the manufacturer after applying all essential requirements from relevant directives

document status can be checked: <https://cert.icrpolska.com/>



Director: Rafal Kalinowski  
Warsaw, 25.08.2022



ICR Polska Co. Ltd.  
[www.icrpolska.com](http://www.icrpolska.com)  
[icrpolska@icrq.com](mailto:icrpolska@icrq.com)

Edycja: 4.1.1.0 of 18.01.2021

## CUSTOMER REVIEW

The collage displays various customer feedback messages and testimonials. Key messages include:

- "Will do now" (2022-08-21 13:52)
- "Submitted" (2022-08-21 13:52)
- "5 stars" (2022-08-21 13:53)
- "great, if I were a girl, I would say I love you" (2022-08-21 13:53)
- "understand" (2022-08-21 13:45)
- "Thanks" (2022-08-21 13:46)
- "my pleasure" (2022-08-21 13:46)
- "Yes sure" (2022-08-21 13:49)
- "Long-term cooperation" (2022-08-21 13:46)
- "That is quite impressive." (2022-08-21 13:49)

There are also several thumbs-up icons and a photo of a modern building.



Customers' recognition is the biggest driving force for our progress!



# X-SPACE



# PREFAB HOUSE

**STICK TO QUALITY**  
**Thank you for choosing X-Spacehome**

+86 187 8327 7613

jack@x-spacehome.com

<https://www.x-spacehome.com>